

14th ANNUAL Iowa Volleyball Coaches Clinic Feb. 29 - March 1, 2008 • Ames, IA

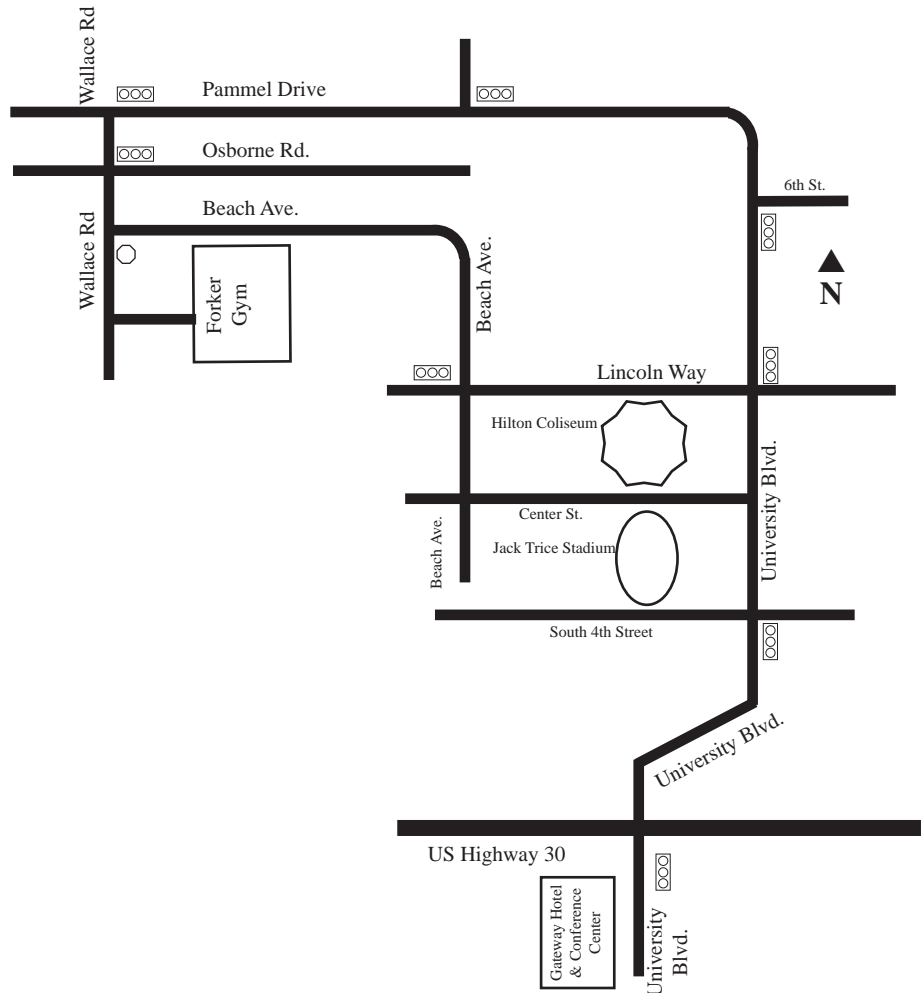

DIRECTIONS TO FORKER GYM

1. Go North (left) on Elwood Drive:
2. Stay on Elwood through the Lincoln Way intersection, and follow the curve, heading West. Elwood turns into Pammel Drive - keep driving West on Pammel:
3. At the stoplight intersection of Pammel and Wallace Road take a left (South):
4. Follow Wallace (thru 1 light - Osborne Dr.) to the three-way stop (Beach Ave.). Continue South thru the stop sign and take first or second left to Forker Gym parking lot.
5. Enter Forker Gym through the West doors, down the stairs and turn left. Rooms 175 and 184 will be down this hall.



* All Registration/Lectures at
Gateway Hotel & Conference Center.

EVENING SESSIONS AT FORKER GYM/ISU CAMPUS

6:30 p.m.

Room 184

*Effective Serve and Serve
Receive Drills*
(Kirsten Bernthal Booth)

Room 175

Training Outside Hitters
(Dawn Sullivan)

7:30 p.m.

Room 184

Training Individual Defense
(Russ Rose)

Room 175

Training Setters
(Terry Gamble)

8:30 p.m.

Room 184

*Situational Wash Drills
and Developing the Proper
Defensive Mentality.*
(Dave Shondell)

Room 175

Building Drills
(Tom Keating)